

ITEM	QTY	DESCRIPTION	LENGTH	UM	PART NUMBER	MATERIAL	TYP	
1	1	BLOCK, FINISH PUNCH HOLDER W/PKO		EA	89NAT2D3BKP60		D	
2	1	SCREW, HORZ. ADJUSTMENT (SHORT)		EA	89NAT2D3BKP55		D	
3	1	SCREW, VERT. ADJUSTMENT		EA	89NAT2D3BKP53		D	
4	1	RETAINER, VERT. ADJ. SCREW		EA	89NAT2D3BKP52		D	
5	2	SCREW, SOC HEAD CAP	.75	EA	91251A540	STEEL	P	
		PURCHASE FROM McMASTER-CARR						
6	1	BLOCK, FINISH CENTERING W/PKO		EA	89NAT2D3BHS11		D	
7	1	PIN, PKO PIVOT		EA	89NAT2D3BKP51		D	
8	1	SCREW, HORZ. ADJUSTMENT (LONG)		EA	89NAT2D3BKP54		D	
9	1	LEVER, PKO		EA	89NAT2D3BKP502		D	
10	1	SETSCREW, IND HEX 1/4"-20	.75	EA	91375A540	STEEL	P	
		PURCHASE FROM McMASTER-CARR						
11	1	NUT, STANDARD 1/4"-20		EA	90499A029	STEEL	P	
		PURCHASE FROM McMASTER-CARR						
12	1	ASSEMBLY, DRAWBOLT		EA	89NAT2D3BKP59A		D	

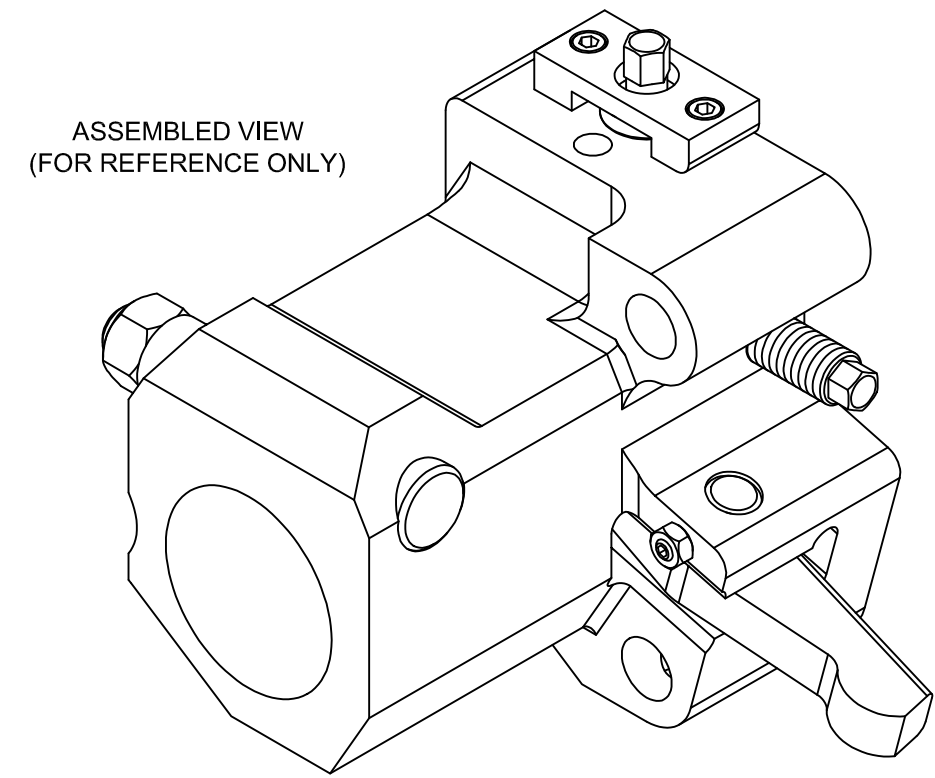

**A** THIS ASSEMBLY IS THE NEWER VERSION OF THIS PART WHERE THE PKO LEVER IS INTEGRATED INTO THE PUNCH HOLDER. THE PKO LEVER IN THE OLDER STYLE ASSEMBLY IS A PART OF THE OSOLATING HEAD. REF: REG-ELLEN ASSEMBLY 89NAT2D3BKP601A.



THIS DRAWING IS THE PROPERTY OF REG-ELLEN MACHINE TOOL. IT SHALL NOT BE COPIED (IN WHOLE OR IN PART), FOR MANUFACTURE OR OTHERWISE DISCLOSED WITHOUT PRIOR WRITTEN CONSENT.

TOLERANCES	
MACHINING	FABRICATION
X. ±.040	ALL ±.06
X.X ±.020	ANGULAR 2°
X.XX ±.010	ALL FINISHES 125mu
X.XXX ±.005	DEBURR ALL SHARP CORNERS OR EDGES
ANGULAR ± 1/2°	

SCALE: 1:1  
 DRAWN BY: MLGATES  
 DATE:  
 CHECKED BY:  
 DATE:

TITLE: NATIONAL 89 2D3B (NEW STYLE) ASSEMBLY, FINISH PUNCH HOLDER  
 SIZE: B SHEET: 1 OF 1 REV:  
 DWG NO: 89NAT2D3BKP60A

AUTOCAD DRAWING: FORM REVISION 13MAR12